

Specification Sheet

NovAseptic[®] Mixer Drive Unit, GMP ATEX

Catalogue Number:

AX###/41-E#-###

Product Description

NovAseptic[®] mixers offer a complete solution for mixing throughout the process line and are designed for a wide variety of mixing applications in the pharmaceutical and biotechnology industries.

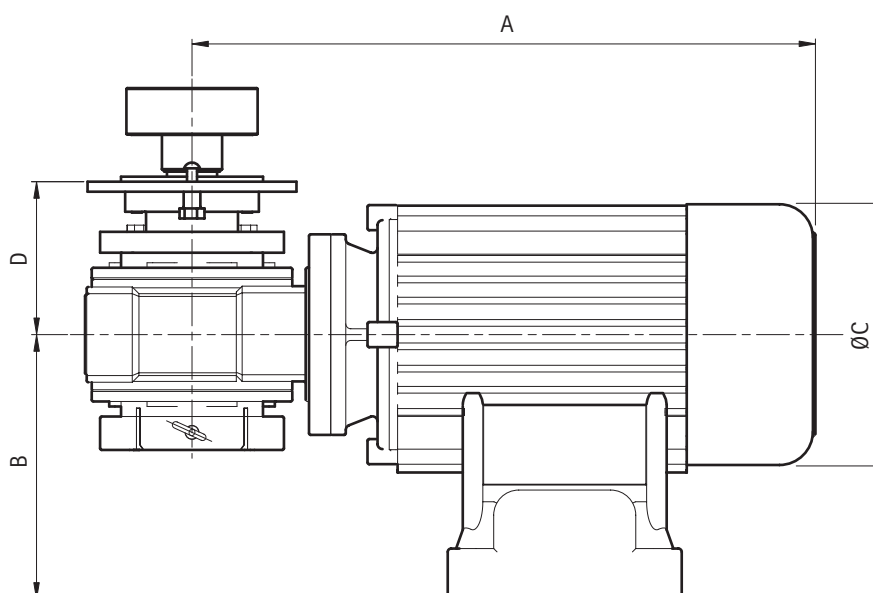

Nominal Dimensions in mm (in.)

AX###/ 41-E#-###	A	B	C	D -E0-###	D -E1-###	D -E2-###	Compatible Mixer			
AX05/41	285 (11.22)	138 (5.43)	124 (4.88)	83 (3.27)	-055	140 (5.51)	-056	—	—	GMP50 ATEX
AX1/41	285 (11.22)	138 (5.43)	124 (4.88)	70 (2.76)	-057	130 (5.12)	-058	170 (6.69)	-059	GMP100 ATEX
AX5/41	285 (11.22)	138 (5.43)	124 (4.88)	70 (2.76)	-060	130 (5.12)	-061	170 (6.69)	-062	GMP500 ATEX
AX10/41	320 (12.60)	147 (5.79)	140 (5.51)	75 (2.95)	-063	—	—	175 (6.89)	-064	GMP1000 ATEX
AX20/41	378 (14.88)	158 (6.22)	164 (6.46)	95 (3.74)	-065	—	—	195 (7.68)	-066	GMP2000 ATEX
AX50/41	378 (14.88)	158 (6.22)	164 (6.46)	100 (3.94)	-067	—	—	200 (7.87)	-068	GMP5000 ATEX
AX100/41	430 (16.93)	167 (6.57)	180 (7.09)	115 (4.53)	-069	—	—	215 (8.46)	-070	GMP10000 ATEX
AX200/41	430 (16.93)	167 (6.57)	180 (7.09)	120 (4.72)	-071	—	—	220 (8.66)	-072	GMP20000 ATEX

Specifications

Net Weight (approximate)

Mixer Size	AX05/41	AX1/41	AX5/41	AX10/41	AX20/41	AX50/41	AX100/41	AX200/41
Weight kg (lb)	18 (39.7)	18 (39.7)	18 (39.7)	23.5 (51.81)	31 (68.3)	31 (68.3)	39.5 (87.08)	42 (92.6)

General Motor Data

Voltage	230/ 400V AC - 50Hz
Number of Poles	2
Degree of Protection	IP 65
Insulating Class	CLF
Ventilation	IC411 (TEFC)
Variable Speed Duty	Quadratic Torque 5 - 50Hz
Thermostat	2 (PTC 110 °C) (PTC 120 °C)
Color	White
Oil	Food grade synthetic, complies with the Code of Federal Regulations (FDA), US 21 CFR 178.3570, 178.3620 and 182

General Revolution Counter Data

Manufacturer	Pepperl - Fuchs
Catalogue No.	NCB1.5-8GM25-N0-V1
Standard	Namur DIN EN 60947-5-6
Labeling	II 1G EEx ia IIC T6, II 1D Ex iaD 20T 108 °C
Degree of Protection	IP 67
Pulses/revolution	1
Cable Length (Detachable)	2 m

Drive Unit Specifications

	Motor						
	Type BEVI	Marking	Max Effect (kW)	Frequency (Hz)	Max Current (A) 230/400V AC *	Speed (rpm) 50Hz	Frame (IEC)
AX05/41	AC75 63B-2	II 2 G Ex de IIC T4 (Inverter rated)	0.25	50	1.5 / 0.85	2805	63 / B14
AX1/41	AC75 63B-2	II 2 G Ex de IIC T4 (Inverter rated)	0.25	50	1.5 / 0.85	2805	63 / B14
AX5/41	AC75 63B-2	II 2 G Ex de IIC T4 (Inverter rated)	0.25	50	1.5 / 0.85	2805	63 / B14
AX10/41	AC75 71B-2	II 2 G Ex de IIC T4 (Inverter rated)	0.55	50	2.4 / 1.4	2830	72 / B14
AX20/41	AC75 80A-2	II 2 G Ex de IIC T4 (Inverter rated)	0.75	50	3.3 / 1.9	2800	80 / B14
AX50/41	AC75 80B-2	II 2 G Ex de IIC T4 (Inverter rated)	1.1	50	- / 2.6	2830	80 / B14
AX100/41	AC75 90S-2	II 2 G Ex de IIC T4 (Inverter rated)	1.5	50	- / 3.1	2870	90 / B14
AX200/41	AC75 90L-2	II 2 G Ex de IIC T4 (Inverter rated)	2.2	50	- / 4.8	2860	90 / B14

	Gearbox				
	Type BEVI	Marking	Ratio (i)	Outer Driving Head Torque (Nm)	Design Speed (rpm)*
AX05/41	FRS 28/FA	II 2GD ck	7	1	50 - 400
AX1/41	FRS 28/FA	II 2GD ck	7	2	50 - 400
AX5/41	FRS 28/FA	II 2GD ck	7	6	50 - 400
AX10/41	FRS 40/PA	II 2GD ck	7	8	50 - 400
AX20/41	FRS 50/PA	II 2GD ck	7	13	50 - 400
AX50/41	FRS 50/PA	II 2GD ck	7	23	50 - 400
AX100/41	FRS 60/PA	II 2GD ck	7	33	50 - 400
AX200/41	FRS 70/PA	II 2GD ck	10	60	35 - 280

* Note: Design Speed is the mechanical limit.

Additional Information

Technical Data	 $0^{\circ}\text{C} \leq T_a \leq +40^{\circ}\text{C}$
Environment Temperature	0 to 40 °C (32 to 104 °F)
Design Pressure	Atmospheric pressure
Operating Speed	Maximum operating speed has to be validated for each process individually, depending on volume, viscosity etc. nually polished
Note	The assembled NovAseptic® Mixer may have different design temperature and/or pressure limits. The weakest component in the assembled product determines the maximum design temperature and pressure limits.
Labeling	Each drive unit is individually labeled for full traceability according to our QA routines.
Packaging	Each drive unit is packaged in a closed box.
Quality Control	Our Quality Assurance System guarantees the control and traceability of the product.



www.emdmillipore.com

EMD Millipore and the M mark are trademarks of Merck KGaA, Darmstadt, Germany.
NovAseptic is a registered trademark of Millipore AB.
Specifications subject to change without notice.
Lit. No. SP1185EN00 Rev. B 09/2013 DP SBU-11-04736 Printed in the USA.
©2013 EMD Millipore Corporation, Billerica, MA, USA. All rights reserved.

To Place an Order or Receive Technical Assistance

In the U.S. and Canada, call toll-free [1-800-645-5476](tel:1-800-645-5476)

For other countries across Europe and the world,
please visit www.millipore.com/offices

For Technical Service, please visit
www.millipore.com/techservice